

Corded Electric Nutrunners

18 Series - Corded Electric - Transducer Control - Inline (2-31 Nm)

Inline tool for applications with torque up to 31 Nm.



- Brushless Operation
- Resolver Control
- Transducer Control
- Memory Intelligence

MODEL	TORQUE RANGE				FREE SPEED RIMIN	WEIGHT		LENGTH		SIDE TO CENTER IN
	MIN NM	MAX NM	MIN FT LB	MAX FT LB		LB	KG	IN		
18ESE06D2	2	6	1.48	4.43	4000	2.43	1.1	11.8	0.91	
18ESE06Q	2	6	1.48	4.43	4000	2.43	1.1	12.3	0.91	
18ESE12D3	3	12	2.21	8.9	1820	2.65	1.2	12.4	0.91	
18ESE12Q	3	12	2.21	8.9	1820	2.65	1.2	13.0	0.91	
18ESE17D3	4	17	2.95	12.5	1290	2.65	1.2	12.4	0.91	
18ESE17Q	4	17	2.95	12.5	1290	2.65	1.2	13.0	0.91	
18ESE22D3	5	22	3.69	16.2	985	2.65	1.2	12.4	0.91	
18ESE31D3	7	31	5.2	22.9	695	2.65	1.2	12.4	0.91	

48 Series - Corded Electric - Transducer Control - Inline (3-150 Nm)

Inline tool for applications with torque up to 150 Nm.



- Brushless Operation
- Resolver Control
- Transducer Control
- Memory Intelligence

MODEL	TORQUE RANGE				FREE SPEED RIMIN	WEIGHT		LENGTH		SIDE TO CENTER IN
	MIN NM	MAX NM	MIN FT LB	MAX FT LB		LB	KG	IN		
48ESE12D2	3	12	2.21	8.9	4000	3.09	1.4	13.0	0.91	
48ESE12Q	3	12	2.21	8.9	4000	3.09	1.4	13.5	0.91	
48ESE25D3	6	25	4.43	18.5	1820	3.31	1.5	13.6	0.91	
48ESE36D3	8	36	5.9	26.6	1290	3.31	1.5	13.6	0.91	
48ESE48D3	10	48	7.4	35.4	985	3.31	1.5	13.8	0.91	
48ESE65D4	13	65	9.6	48	750	5.3	2.4	16.6	1.14	
48ESE90D4	19	90	14.0	66	510	5.5	2.5	17.1	1.14	
48ESE125D4	26	125	19.2	92	360	5.5	2.5	17.1	1.14	
48ESE150D4	31	150	22.9	111	240	5.5	2.5	17.1	1.14	

18 Series - Corded Electric - Transducer Control - Inline - Floating Spindle (2-17 Nm)

Inline Floating Spindle tool for applications with torque up to 17 Nm.

- Brushless Operation
- Resolver Control
- Transducer Control
- Memory Intelligence

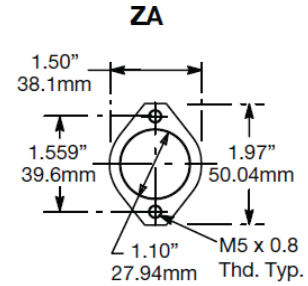

Dimensional tolerances = $\pm .004$ " (0.1mm)
Spindle Float: 1" (25mm) ZA

MODEL	TORQUE RANGE				FREE SPEED	WEIGHT		OUTPUT DRIVE	LENGTH	SIDE TO CENTER
	MIN NM	MAX NM	MIN FT LB	MAX FT LB		RIMIN	LB		KG	IN
18ESE06ZA	2	6	1.48	4.43	4000	3.09	1.4	1/4 SQUARE DRIVE	15.5	0.91
18ESE12ZA	3	12	2.21	8.9	1820	3.31	1.5	1/4 SQUARE DRIVE	16.0	0.91
18ESE17ZA	4	17	2.95	12.5	1290	3.31	1.5	1/4 SQUARE DRIVE	16.0	0.91

Corded Electric Nutrunners

48 Series - Corded Electric - Transducer Control - Inline - Floating Spindle (3-248 Nm)

Inline Floating Spindle tool for applications with torque up to 248 Nm.

- Brushless Operation
- Resolver Control
- Transducer Control
- Memory Intelligence

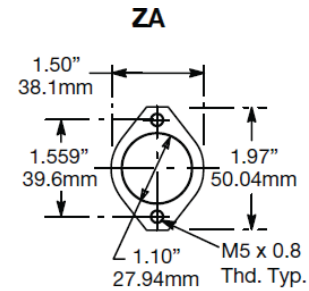

Dimensional tolerances = $\pm .004"$ (0.1mm)
Spindle Float: $1"$ (25mm) ZA

MODEL	TORQUE RANGE				FREE SPEED		WEIGHT		OUTPUT DRIVE	LENGTH	SIDE TO CENTER
	MIN NM	MAX NM	MIN FT LB	MAX FT LB	RIMIN	LB	KG	IN		IN	
48ESE12ZA	3	12	2.21	8.9	4000	3.31	1.5	1/4 SQUARE DRIVE	16.7	0.91	
48ESE271ZB	8	27	5.9	19.9	1820	5.7	2.6	3/8 SQUARE DRIVE	22.0	0.91	
48ESE361ZB	7	36	5.2	26.6	1290	5.7	2.6	3/8 SQUARE DRIVE	22.0	0.91	
48ESE602ZB	11	57	8.1	42.1	855	8.4	3.8	1/2 SQUARE DRIVE	24.4	1.1	
48ESE702ZB	14	68	10.3	50	570	8.4	3.8	1/2 SQUARE DRIVE	24.4	1.1	
48ESE802ZB	17	82	12.5	61	450	9.7	4.4	1/2 SQUARE DRIVE	26.7	1.1	
48ESE1152ZB	25	115	18.5	85	320	9.7	4.4	1/2 SQUARE DRIVE	26.7	1.1	
48ESE1502ZB	31	150	22.9	111	245	9.7	4.4	1/2 SQUARE DRIVE	26.7	1.1	
48ESE1653ZB	33	165	24.4	122	220	14.6	6.6	3/4 SQUARE DRIVE	28.6	1.57	
48ESE2503ZB	50	248	36.9	183	145	14.6	6.6	3/4 SQUARE DRIVE	28.6	1.57	

18 Series - Corded Electric - Transducer Control - Inline - Push to Start (2-12 Nm)

Push to Start Inline tool for applications with torque up to 12 Nm.

- Brushless Operation
- Resolver Control
- Transducer Control
- Memory Intelligence



MODEL	TORQUE RANGE				FREE SPEED		WEIGHT		LENGTH	SIDE TO CENTER
	MIN NM	MAX NM	MIN FT LB	MAX FT LB	RIMIN	LB	KG	IN	IN	
18ESE06D3P	3	6	2.21	8.9	4000	2.87	1.3	14.2	0.91	
18ESE06QP	2	6	1.48	4.43	4000	2.87	1.3	14.8	0.91	
18ESE12D3P	3	12	2.21	8.9	1820	3.09	1.4	14.2	0.91	
18ESE12QP	3	12	2.21	8.9	1820	3.09	1.4	14.8	0.91	

48 Series - Corded Electric - Transducer Control - Crowfoot (10.5-30 Nm)

Multiple socket configurations and head angles for bolts on hard to reach applications.

- Brushless Operation
- Resolver Control
- Transducer Control
- Memory Intelligence



Nutrunners & Screwdrivers

Nutrunners & Screwdrivers

MODEL	TORQUE RANGE				FREE SPEED RIMIN	WEIGHT		LENGTH	
	MIN NM	MAX NM	MIN FT LB	MAX FT LB		LB	KG	IN	
48ECE30C1	10.5	30	7.7	22.1	860	5.5	2.5	20.5	
48ECE30C3	10.5	30	7.7	22.1	860	5.5	2.5	20.5	

48 Series - Corded Electric - Transducer Control - Tubenut (10-40 Nm)

Multiple head types and over 500 socket configurations to fit any fluid line application.

- Brushless Operation
- Resolver Control
- Transducer Control
- Memory Intelligence



MODEL	TORQUE RANGE				FREE SPEED RIMIN	WEIGHT		LENGTH	
	MIN NM	MAX NM	MIN FT LB	MAX FT LB		LB	KG	IN	
48ETE20T2	10	20	7.4	14.8	1425	4.41	2.0	16.9	
48ETE30T3	15	30	11.1	22.1	1030	4.41	2.0	16.6	
48ETE40T4	20	40	14.8	29.5	770	5.3	2.4	17.9	